



ZONING PERMIT APPLICATION

BOROUGH OF HUMMELSTOWN
261 QUARRY ROAD
HUMMELSTOWN PA 17036
PHONE: (717) 566-2555 FAX: (717) 566-3324
www.hummelstown.net

Permit No _____
Date Received _____
Application Fee: \$50.00 Res
\$100.00 Non-Res

Location of Property (Legal Address):	
<input type="checkbox"/> Property Owner <input type="checkbox"/> Tenant <input type="checkbox"/> Contractor Name: _____ Address: _____ City/State/Zip: _____ Phone #: _____ Email Address: _____	<input type="checkbox"/> If Applicant is not the Property Owner Property Owner Information: Name: _____ Address: _____ City/State/Zip: _____ Phone #: _____
Proposed Work being completed by: <input type="checkbox"/> Property Owner <input type="checkbox"/> Contractor Project Contact Person _____ Contact Phone Number _____	
Work Proposed: <input type="checkbox"/> Residential <input type="checkbox"/> Non-Residential <input type="checkbox"/> CHANGE OF USE <input type="checkbox"/> NEW BUILD <input type="checkbox"/> ADDITION <input type="checkbox"/> DEMOLITION <input type="checkbox"/> FENCING <input type="checkbox"/> DECK / PATIO <input type="checkbox"/> ACCESSORY STRUCTURE (SHED, GARAGE, ETC.) <input type="checkbox"/> PARKING LOT / DRIVEWAY <input type="checkbox"/> SWIMMING POOL <input type="checkbox"/> OTHER: _____	
Existing Use: _____ Proposed Use: <input type="checkbox"/> One Family <input type="checkbox"/> Two or more Family / No. of units _____ <input type="checkbox"/> Accessory Structure <input type="checkbox"/> Garage <input type="checkbox"/> Carport <input type="checkbox"/> Other	
Setbacks (Current and/or Proposed) Front _____ Rear _____ Left _____ Right _____	<u>Cost of Improvement:</u> Total Cost \$ _____
<u>DETAILED DESCRIPTION OF PROPOSED WORK:</u> _____ _____ _____	

Applications require a detailed plat plan of the property with measurements for all impervious coverage, to include everything that is NOT grass, mulch, or vegetation.

Fencing applications need a detailed sketch of the fence placement in relation to the property line and structures must include gate locations.

IDENTIFICATION AND VERIFICATION

(To be completed by the applicant, authorized agent, or contractor)

I hereby certify that the proposed work, as contained in this application, is authorized by the owner of record and that I have been authorized by the owner to make this application as his authorized agent. I also certify and acknowledge that review and approval of plans, applications and the issuance of permits does not relieve the owner from building and constructing all structures in accordance with all applicable Building Codes and other applicable ordinances of the Borough of Hummelstown

Signature of Applicant

Date

Zoning Permit Application needed information

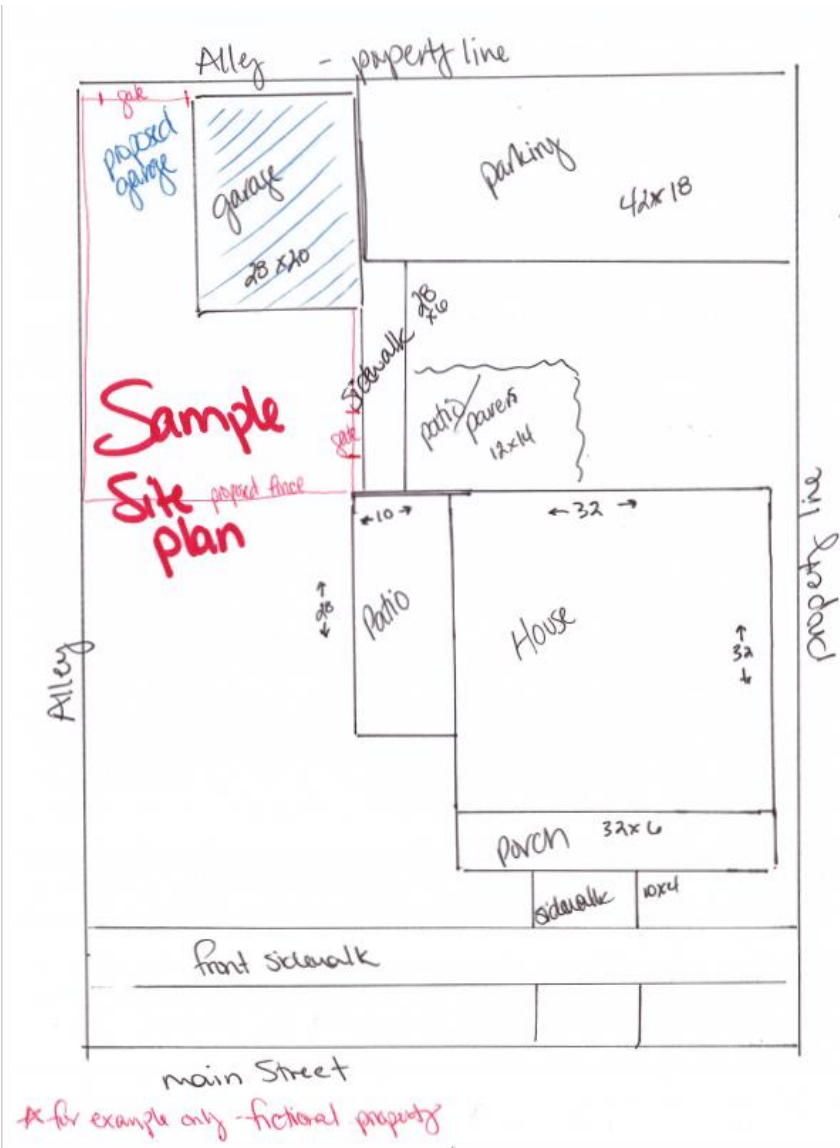

Site plan must include the following

- Current measurements of all impervious coverage
- Proposed location and measurements
- Frontage sidewalks are not calculated in the impervious coverage totals however should be marked on the site plan.
- Height of proposed accessory structures
- Setbacks from property lines for proposed projects

Fences (new and/or replacement) must include:

- Location of fence
- Location of gates
- Description of fencing materials
- Total length of fencing
- Proposed height of fencing
- If the property has a pool, self-latching, self-closing gate(s) must be included.

Change of Use Applications must include:

- What the use currently is
- What the proposed use will be
- Any needed modifications to the exterior or interior of the building.

If Changing the Use to a business the following information must be included:

- What the current use is / current business is
- Current available parking on the same lot as the proposed business
- Completed a business registration form